

PREFEITURA DE TRÊS CORAÇÕES  
ARQUITETURA DE OBRAS

1	10000
2	20000
3	30000
4	40000
5	50000
6	60000
7	70000
8	80000
9	90000
10	100000
11	110000
12	120000
13	130000
14	140000
15	150000
16	160000
17	170000
18	180000
19	190000
20	200000

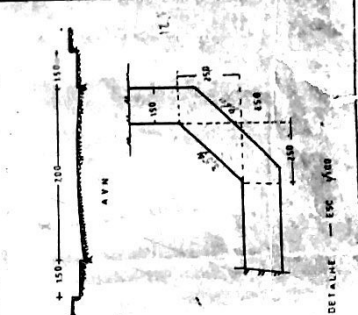

PLANTA ESCALA 1/500

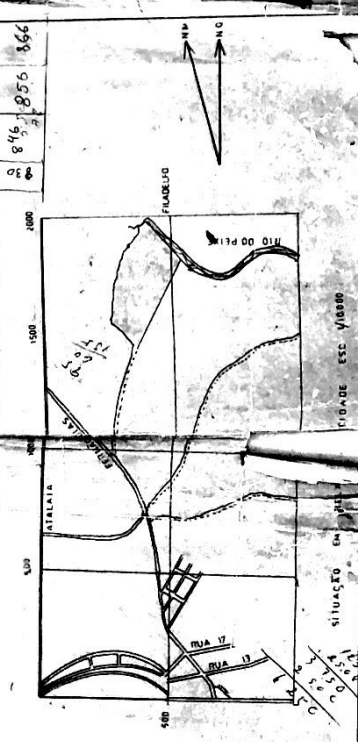

875 Rua 17

TUB. MANEJO

DESPACHO

SITUAÇÃO ALTIMÉTRICA





anda para  
Edra do II



